

MITCHELL

E100.E150.E200

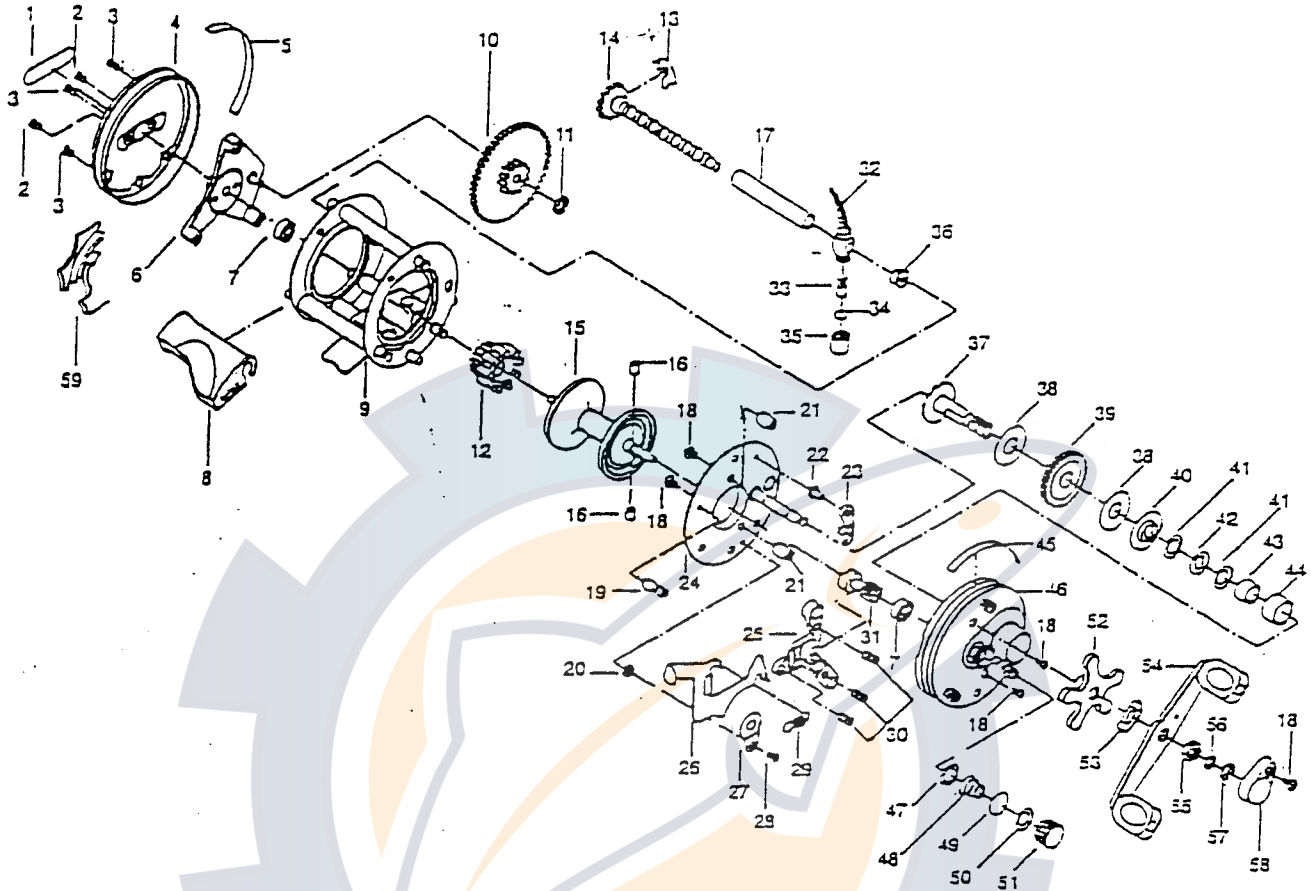

ITEM	EPIC 100	EPIC 150	EPIC200	DESCRIPTION	ITEM	EPIC 100	EPIC 150	EPIC 200	DESCRIPTION
1	888-2567			SIDE COVER DECAL	30	888-2606			YOKE SPRING
2	888-2568			TRANSVERSE SCREWS	31	888-2607			PINION GEAR
3	888-2569			SIDE PLATE SCREW	32	888-2608			LINE GUIDE
4	888-2570		888-2054	LEFT SIDE PLATE	33	888-2609			TRAVERSE CLAW
5	888-2571			LEFT SIDE COVER LABEL	34	888-2610			CLAW PRESSURE DISK
6	888-2572			TRANSVERSE GEAR FRAME	35	888-2611			LINE GUIDE CAP
7	888-2573			BALL BEARING	36	888-2612			BUSHING
8	888-2574	888-2575	888-2576	REMOVABLE THUMB REST	37	888-2613			CRANK SHAFT
9	888-2577	888-2578	888-2579	MAIN BODY ASSEMBLY	38	888-2614			DRAG FRICTION DISK
10	888-2580			TRANSVERSE GEAR	39	888-2615			MAIN GEAR
11	888-2581			TRANSVERSE SPRING	40	888-2616			DRAG PRESSURE PLATE
12	888-2582			TRANSVERSE PINION GEAR	41	888-2617			DRAG WASHER
13	888-2583			CAM GEAR RETAINER	42	888-2618			DRAG SPRING WASHER
14	888-2584	888-2585	888-2586	CAM GEAR ASSEMBLY	43	888-2619			DRAG PRESSURE INSERT
15	888-2587	888-2588	888-2589	SPOOL ASSEMBLY	44	888-2620			MAIN SHAFT BEARING
16	888-2590			CENTRIFUGAL BRAKE SHOE	45	888-2621			RIGHT SIDE COVER LABEL
17	888-2591	888-2592	888-2593	TRANSVERSE CAM PIPE	46	888-2622			RIGHT SIDE PLATE
18	888-2594			MULTI PURPOSE SCREW	47	888-2623			O-RING
19	888-2595			LATCH GUIDE POST	48	888-2624			CAST CONTROL SPRING
20	888-2596			KEEPER SPACER	49	888-2625			CAST CONTROL PRESSURE DISK
21	888-2597			YOKE GUIDE	50	888-2626			CAST CONTROL PRESSURE RING
22	888-2598			ANTI-REVERSE CLAW POST	51	888-2627			CAST CONTROL KNIFE
23	888-2599			ANTI-REVERSE CLAW ASSEMBLY	52	888-2628			STAR DRAG ASSEMBLY
24	888-2600			SET PLATE ASSEMBLY	53	888-2629			HANDLE SPRING WASHER
25	888-2601			YOKE	54	888-2630			CRANK HANDLE ASSEMBLY
26	888-2602			THUMB LATCH	55	888-2631			HANDLE RETAINING NUT
27	888-2603			LATCH KEEPER	56	888-2632			SHIM WASHER
28	888-2604			KEEPER SCREW	57	888-2633			SPRING
29	888-2605			LATCH SPRING	58	888-2634			RETAINING CAP
					59			888-2053	CLOSER ASSEMBLY